

TERMINAL, COMPLIANT

MATERIAL: PIN - COPPER ALLOY
 BANDOLIER - COPPER ALLOY
 OR C.R. STEEL

PLATING: TBD BY CUSTOMER

DIMENSION IN MM [INCHES]

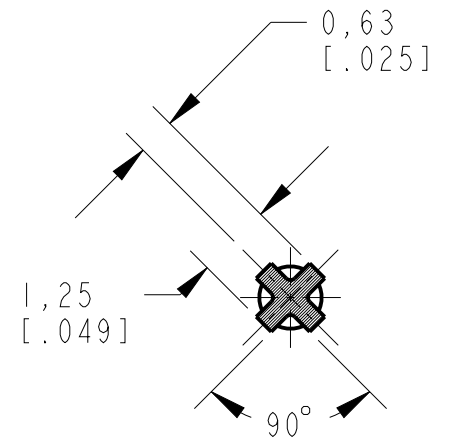

COMPLIANT DETAIL

P/N	DIM "A"	DIM "B"	DIM "C"
8000T 105-1	24 [.945]	6.3 [.248]	13.6 [.535]
8000T 105-2	25.9 [1.019]	8.2 [.323]	13.6 [.535]
8000T 105-3	32.9 [1.295]	15.2 [.598]	13.6 [.535]
8000T 105-4	25.4 [1.000]	7.7 [.303]	13.6 [.535]
8000T 105-5	32.4 [1.275]	14.7 [.579]	13.6 [.535]
8000T 105-6	22.9 [.901]	8.8 [.346]	10 [.394]
8000T 105-7	32.9 [1.295]	8.8 [.346]	20 [.787]